

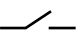



13.71

	13.71.8.230.0000 U_N 230 V AC (50/60 Hz) U_{min} 195.5 V AC U_{max} 264.5 V AC
	1 NO (SPST-NO) 10 A 230 V AC μ  (230 V AC) 1000 W  (230 V AC) 350 W
	(-10...+60)°C
IP20	
	15 (1.0 mA)

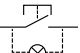
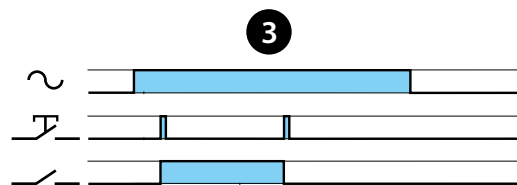
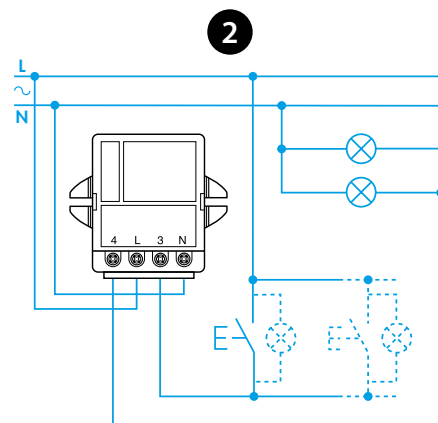
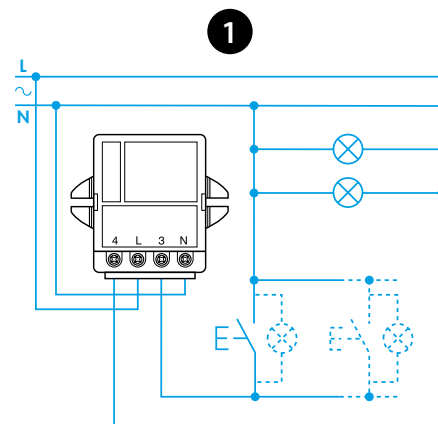
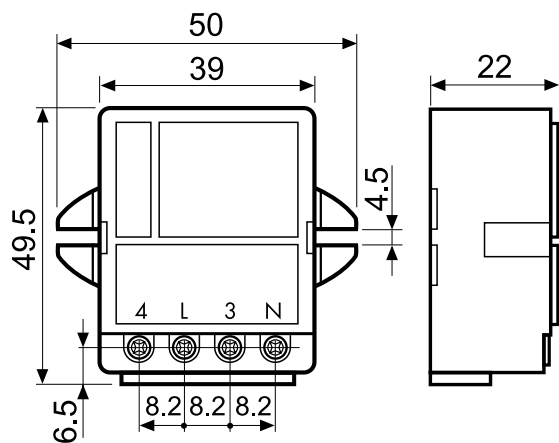

FRANCAIS

13.71 TELERUPTEUR ELECTRONIQUE SILENCIEUX

- 1** SCHEMA DE RACCORDEMENT 3 FILS
- 2** SCHEMA DE RACCORDEMENT 4 FILS
- 3** FONCTIONS
RI - Télérupteur

NOTE
ATTENTION: pour la fixation, utiliser des vis \varnothing 4 mm